

Bluetooth Keyboard Quick Start Guide

1. Controls

OFF/ON Slide switch to ON position to power unit on or to OFF position to turn off.

connect Press the Bluetooth connect button to establish wireless keyboard connection with tablet PC.

2. Keyboard Indicator Lamp

power Battery Status Light: Slide the OFF/ON switch to ON. The power light will illuminate for 3 seconds. The keyboard will remain powered on even though the light turns off.

BT Bluetooth Status Light: Press the "Connect" button and the Bluetooth status light will flash. This indicator light remains on until the keyboard connects to your device.

CAPS Caps Lock Indicator: Indicator is lit when the keyboard is set to uppercase text mode.

Charge Charging Light: While charging, the charging indicator illuminates red color. Once it is fully charged, the red indicator will turn off.

3. Connecting the Keyboard to the Tablet

To connect the Bluetooth keyboard to the tablet, follow these steps:

- Turn the keyboard power switch to the ON position. The power indicator light will stay on for about five seconds, and then the indicator light will turn off.
- Then press the "Connect" button, the Bluetooth indicator light will flash. The keyboard is now ready to connect to the tablet.
- On the tablet, from the Start screen, go to the "Settings" menu (click the icon), then select "PC and devices".



1

4. Charging the Bluetooth Keyboard

When battery power is running low, the power light will start flashing indicating that you need to recharge the keyboard.

Step 1: Attach the long USB cable (included with this keyboard) to the short transfer cable (included with the tablet).

Step 2: Connect the long USB cable to the keyboard's USB port and the other end to the tablet.

NOTE: Tablet must be powered on to charge the keyboard.

If battery level on the tablet is low, plug in AC power adapter to recharge.

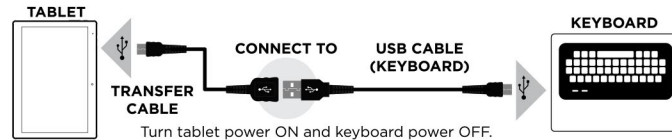

5. Battery

The long-lasting lithium ion rechargeable battery will provide many hours of service with no "memory effect" so the battery can be recharged at any time. We recommend that you turn the keyboard off during long periods of inactivity.

6. Energy Saving Sleep Mode

The keyboard automatically enters an idle, or sleep mode, when it is inactive for 15 minutes. At that time, the keyboard power will turn off. To resume normal operation, or wake up the keyboard from sleep mode, press any key and wait about 3 seconds for the keyboard to reset.

7. Product Features:

- Bluetooth wireless keyboard.
- Protective case with integrated kickstand.
- Micro USB interface for easy recharging.
- Long lasting, built-in rechargeable lithium battery.
- Light weight, quiet keystrokes.
- Energy saving sleep mode.

3

d) Select and set "Bluetooth".

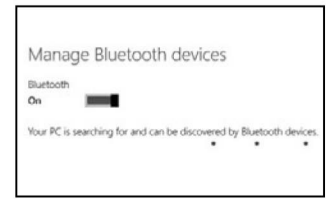

e) The tablet computer will automatically search for the available Bluetooth keyboard device and show that it is "Ready to Pair" with the tablet. Select "Pair".

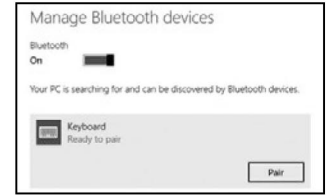
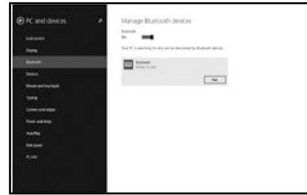

f) Use the keyboard to enter the password code as displayed on screen

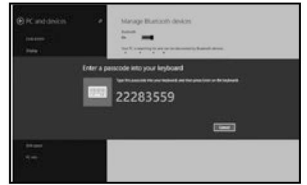

g) The tablet will show "Connected" once the Bluetooth connection has been established.

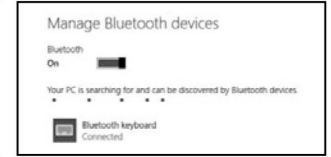

2

8. Function Keys

Hold the [Fn] key while selecting the desired special keys.



	Search		Rewind		Home
	Brightness -		Play/Pause		Enhanced Functions
	Brightness+		Forward		
	Device		Mute		
	Setting		Volume Down		
	Share		Volume Up		

9. Keyboard Specification

Bluetooth interface standard	Standby time: >40 days
Operating distance up to 30 feet	Charge time: <2 hours
Modulation system: GFSK	Lithium battery capacity: 180mAh
Operation voltage: 3.0-5.0v	Operating time: Up to 40 hours
Operating current: <2.5mA	Lithium battery life: Up to two years
Standby current: <0.3mA	Key Strength: 80 +/- 10g
Sleep current: <40uA	Working temperature: -10 - +55 C
Charge current: 200mA	

10. Safety Precaution

- Keep the keyboard away from sharp objects.
- Do not place heavy objects on the keyboard.
- Do not expose the keyboard to microwaves.
- Do not apply undue force or pressure on the keyboard.
- Keep keyboard away from oil, chemicals or any other organic liquids.
- Warning: This product may contain a chemical known to the State of California to cause cancer, birth defects, or other reproductive harm.
- Clean the keyboard with water, diluted alcohol or light cleaning solution.

4